

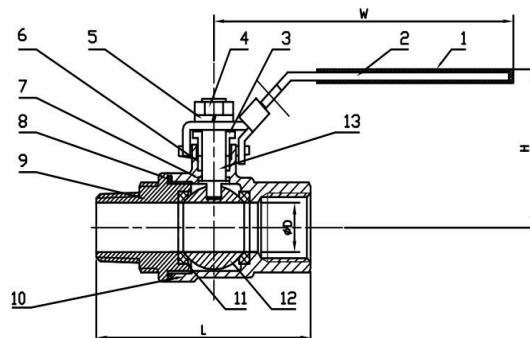

Cangzhou Changyuan Fittings Co.,Ltd

Add:No.26 Shigang Road,Development Zone,Cangzhou ,Hebei,China

[Http://www.con-well.com](http://www.con-well.com) email:con-well@vip.163.com



2PC BALL VALVE M/F (FULL BORE) (mm)

Type III

DN	G	D	L	H	W
8	1/4"	9.00	50.00	42.00	75.00
10	3/8"	12.50	52.50	42.00	75.00
15	1/2"	15.00	63.00	48.00	85.00
20	3/4"	20.00	70.00	51.00	100.00
25	1"	25.00	83.00	61.00	105.00
32	1 1/4"	32.00	97.00	78.00	120.00
40	1 1/2"	38.00	107.00	82.00	120.00
50	2"	50.00	131.00	95.00	160.00

MATERIAL LIST

ITEM	DESCRIPTION	MATERIAL
1	PLASTIC COVER	PLASTIC
2	HANDLE	201/304
3	GLAND NUT	304
4	STEM NUT	304
5	THRUST WASHER	304
6	STEM PACKING	PTFE
7	STEM SEAL	PTFE
8	BODY SEAL	PTFE
9	CAP	CF8/CF8M
10	BODY	CF8/CF8M
11	BALL SEAT	RPTFE
12	BALL	304/316
13	STEM	304

FEATURES:

- Handle with lock can be choiced.
- Working pressure:1000PSI(PN64).
- Working temperature:-10℃ to 150℃.
- Suitable medium:W.O.G.
- Thread: BSP,BSPT,DIN,NPT.
- PED97/23/EC(CE0038)Approved.
- Inspection Testing:API598,EN12266.